

MURPHY YUKON

Elevator Assembly

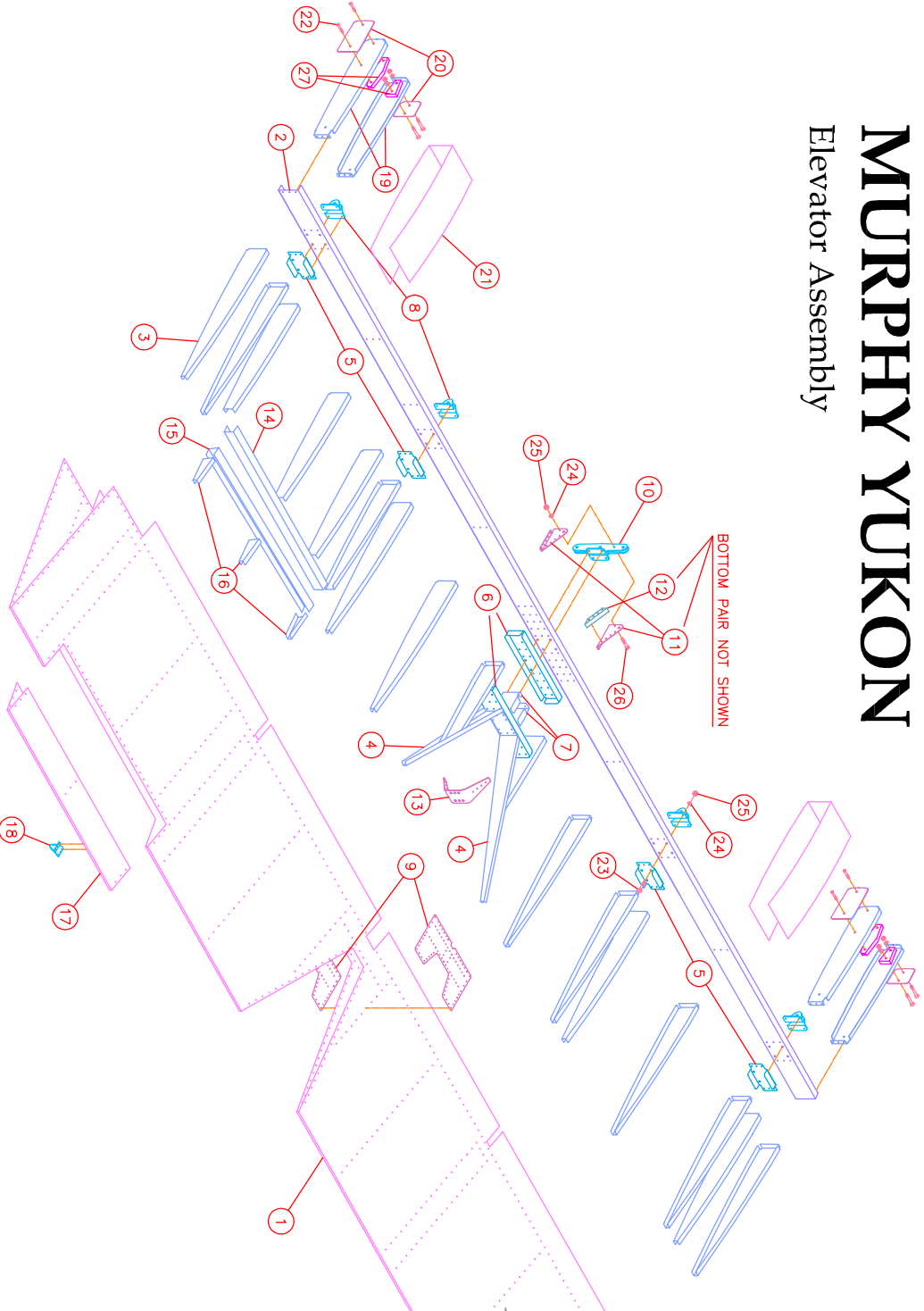

YUKON ELEVATOR PARTS LIST			
ITEM	DESCRIPTION	PART NUMBER	QTY
1	ELEVATOR SKIN	ELO455	1
2	ELEVATOR SPAR	ELO309	1
3	ELEV/RUD RIB	ELO303	17
4	ELEV/RUD RIB DIAGONAL	ELO450	4
5	ELEV/RUD HINGE DOUBLER	ELO307	4
6	ELEV CENTER DOUBLER	ELO304	2
7	STIFFENER RIB	ELO312	2
8	ELEV/RUD HINGE	ELO300	8
9	ELEV CENTER GUSSET	ELO451	2
10	ELEV/RUD HORN	ELO301	2
11	ELEVATOR HORN DOUBLER*	ELO454	1
	(2L+2R MADE FROM ELO454)		
12	HORN DOUBLER SPACER*	ELO453	1
13	HORN STRAP*	ELO452	1
14	FRONT TRIM SPAR	ELO314	1
15	REAR TRIM SPAR	ELO315	1
16	TRIM RIB CUT FROM ELO303		
17	TRIM SKINCUT FROM ELO310		
18	TRIM HORN*	EL1001	1
19	TIP RIB	ELO402	2
20	TIP WEIGHT BACKING PLATE*	ELO412	2
21	ELEVATOR TIP SKIN	ELO322	1
22	MACHINE SCREW	AN509-1032R19	2
23	BOLT	AN3-4A	8
24	WASHER	AN960-1060	32
25	FIBER NUT	AN365-1032	30
26	BOLT	AN3-10A	2
27	ELEVATOR TIP WEIGHT	ELO037	3
PARTS NOT SHOWN			
	PIANO HINGE	1419-DOOSS	1
	AVEX RIVET	RV1613	10
	1/8" x 3/16" AVEX RIVET	RV1410	2500
	MACHINE SCREW FOR SERVO	AN525-832R10	4
	WASHER FOR SERVO	AN960-8	4
	FIBER NUT FOR SERVO	AN365-832	4
	ELEV/RUD INSPECTION COVER	ELO409	4
	SERVO BACKING PLATE	ELO316	1
	CRUSH TUBE	ELO032	1
	REINFORCING ANGLE	ST0040 (24")	1

* CUSTOMER MAKES FROM RAW STOCK